

Adjudication Activities Co-Location Facility



Project Information

- 150,000 SF
- 3 Story Office Building
- Architectural and Structural were done in Revit.
- Other Disciplines were done in AutoCAD 2006 with backgrounds exported from Revit.



Project Planning

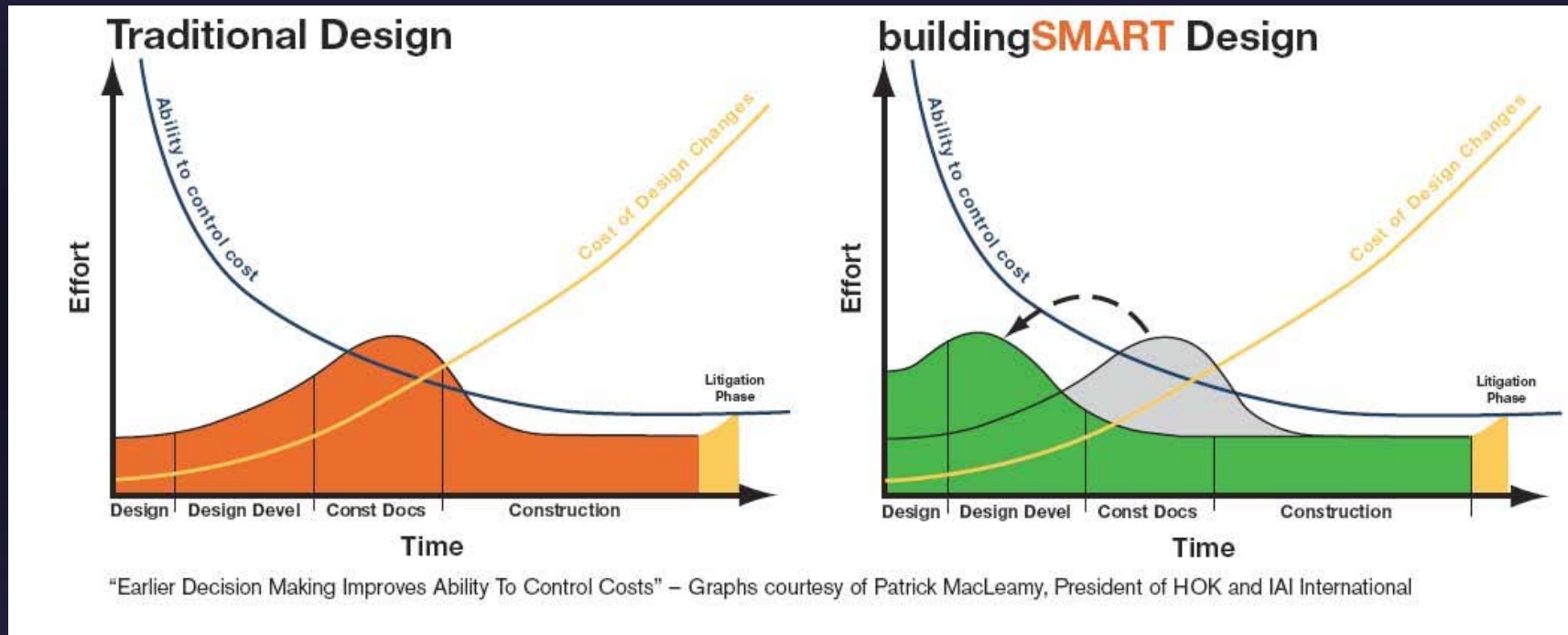

image source: http://construction.ecnext.com/mcgraw_hill/includes/SMRI.pdf

- Plan for multiple people working on the model (Revit – worksets).

Team Coordination

- Architectural and Structural in Revit with Linked Models.
- Linked models were regularly checked for interferences and coordination.
- MEP in AutoCAD with backgrounds exported from Revit.

Team Coordination

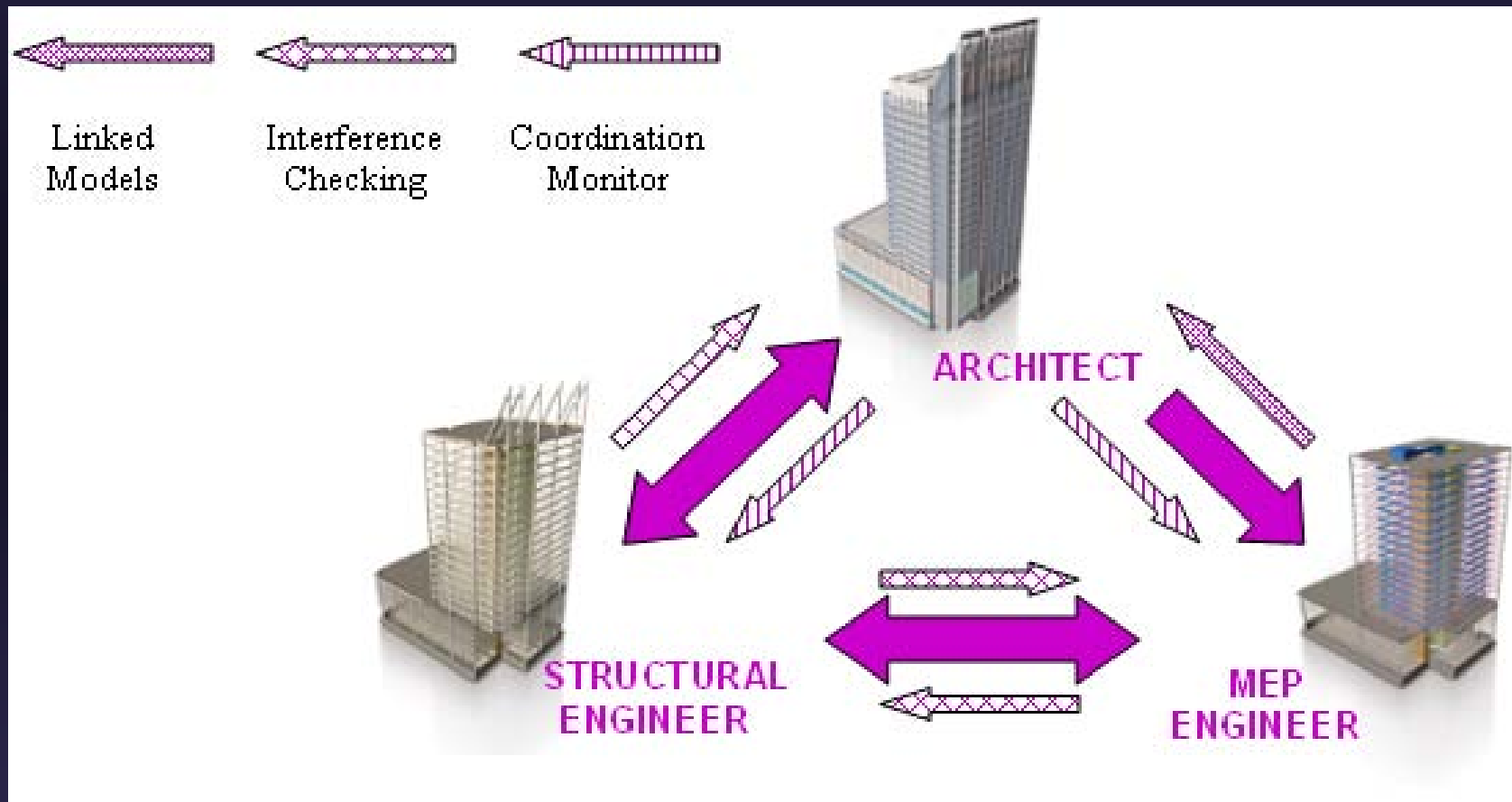

Team Coordination - Strategies

- Discuss who “owns” what.
- Example – CMU Shafts:
 - Architectural for window & door placement.
 - Structural for structural analysis.
- View settings must be coordinated.

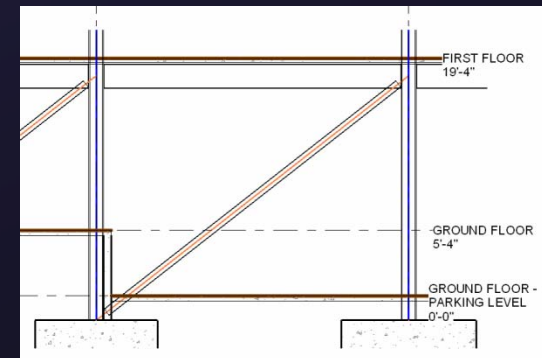
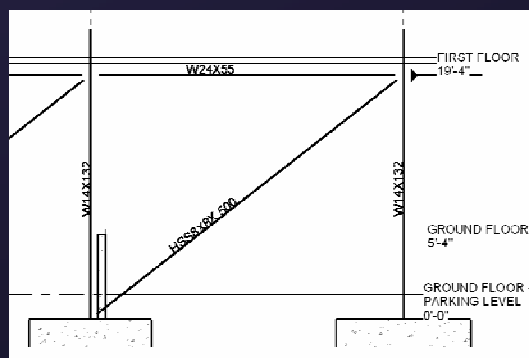
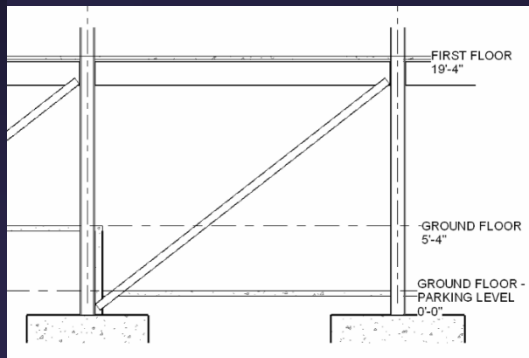

Design Process - Schematic Design

- Requires more input from designers and senior staff due to decisions being made sooner.
- Don't "cut corners" on the model.
- Model can be built quickly for future design flexibility – it's a balance.

Design Process - Schematic Design

- Coordinate with other disciplines.
- Model windows as windows.
- Pay attention to bottom and top of walls.
- Model doors with sidelights as such, not doors with a window beside it.
- Pay attention to material changes.
- Don't over model! Use 2D model elements where ever possible.

Design Process - Construction Documents

- Detailing is much easier than anticipated.
- If you get through Design Development and maintain a quality model, then Construction Documentation is simple.

Design Process - Construction Documents

- Tough to overcome the AutoCAD mentality.
- Remember, it's a model with multiple views.
- Avoid last minute changes.
- Use caution when using the model for presentations or walkthroughs with little time.

Results

- Like other programs, when to start in Revit is still debated.
- Better coordinated documentation.
- Most staff does not want to go back to AutoCAD or Microstation.

Questions

